

Over the past decade six of the world's ten fastest-growing countries were African. In eight of the past ten years, Africa has grown faster than East Asia, including Japan. [...] Africa now has a fastgrowing middle class: according to the World Bank, around 60m Africans have an income of \$3,000 a year, and 100m will in 2015. The rate of foreign investment has soared around tenfold in the past decade.

THE ECONOMIST
Africa rising, Dec 3rd, 2011

65 000 000 000 000 \$

FDI - Foreign direct investment - anno 2012

The darkest thing about Africa has always been our ignorance of it.

George Kimble
geographer

Africa is the second continent in size and population, but we don't know enough about his landscapes. In the last decade, there's a new form of colonization (exploration). Today, the process of exploration is informative: the relationship between space, memory and representation in the digital age have increased thanks to the process of communication, which can be found in the everyday cultural experience. This is a direct method of interpretation of the territory. Recording and processing the output of the landscape, you can make synthetic multi-dimensional maps (with a new semantics), which express the physical variables and intangible assets. The transformation of the landscape (due to socio-economic, political and climate change variables), can't be represented only with traditional medium, but with the layerization of space-time movement. Build a landscape atlas according to this method, accelerates a cognitive process of interpretation; an open database allows you to create devices and applications based on direct experience of exploration. And encouraging the debate on the uncertain definition of landscape.

**30221532 Km².
HOW MANY LANDSCAPES ?**

SURVEY

THE TRIP

SELECTION AND SET-UP OF VIEWPOINT
(Viewpoint set-up + air balloon launch)

DATA COLLECTION OUTPUT OUTPUT PROCESSING

(Output archive)

Air temperature;
Relative humidity;
Thermal radiation;
Wind direction and wind-force;
Water temperature.

Magnetic and electromagnetic field.

GPS tracks;
Height above level sea;
Morphological and topographical field.

Aerial photography;
Sky and earth colour;
Collection of soil, fossil, water samples.

Spacewater frequency;
Sound frequency of landscapes.

Books and documents about exploration;
Population questionnaires and dossiers;
Flora, fauna and natural history questionnaires and dossiers.

(through geographic information system applications)

MAP-MAKING
(geo-data visualization)

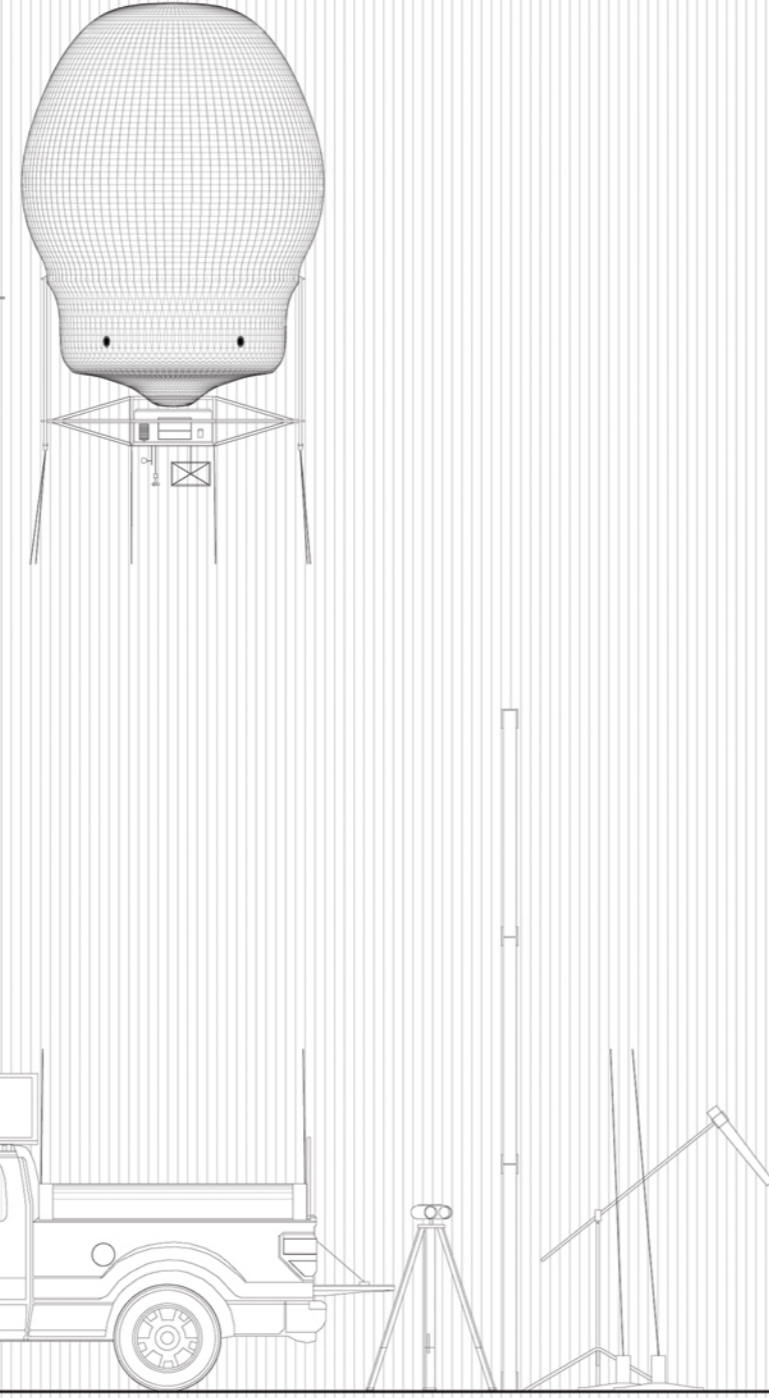

TOOLS

- Personal belongings
- PPE
- Oxygen mask
- Nitrile
- Dianlectant
- Smoke bomb
- Signal flairs
- First aid
- Long-life food
- Water tank
- Water purifier
- Tent
- Tent assembly kit
- Sleeping bag
- Camp stove
- Gas cylinder
- Generator
- Mechanical tools
- Spare part
- Fuel tank
- Engine oil tank
- Battery

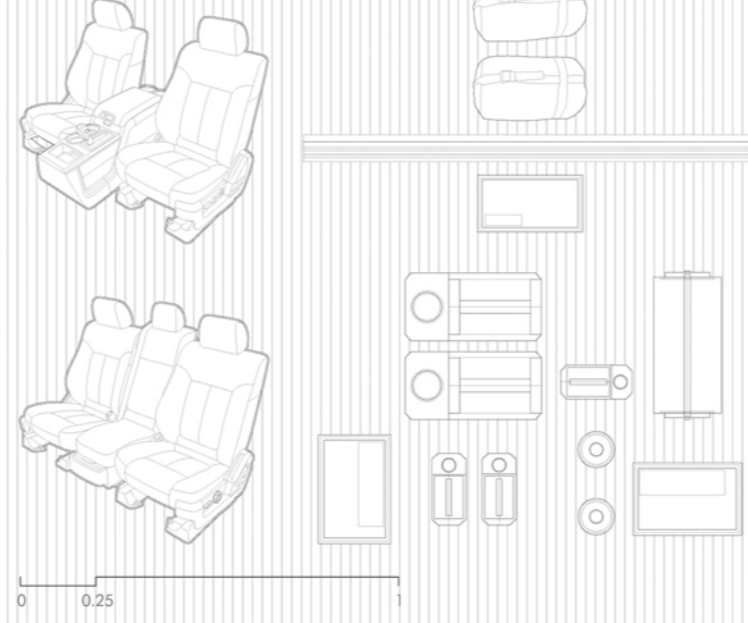

TOOLS

- Mortar maker kit
- Reflex camera
- Lens
- USB wires
- Ni/Book
- Go/Pro camera
- Photoscope
- Shotgun microphone
- Pocket projector
- Topographic kit
- Electronic theodolite
- Radar reflector
- Surveying kit
- Sextant
- Timer
- Thermometer
- Compass
- Cyanometer
- Gaussmeter
- Lab.kit
- Archaeological kit
- Chemical kit
- Color sprays
- Scientific texts
- Ethnographic texts



TOOLS

- Tripsods
- Prism
- Telescopic rod
- Hydrogen cylinders
- Shovel
- Pick
- Cordage

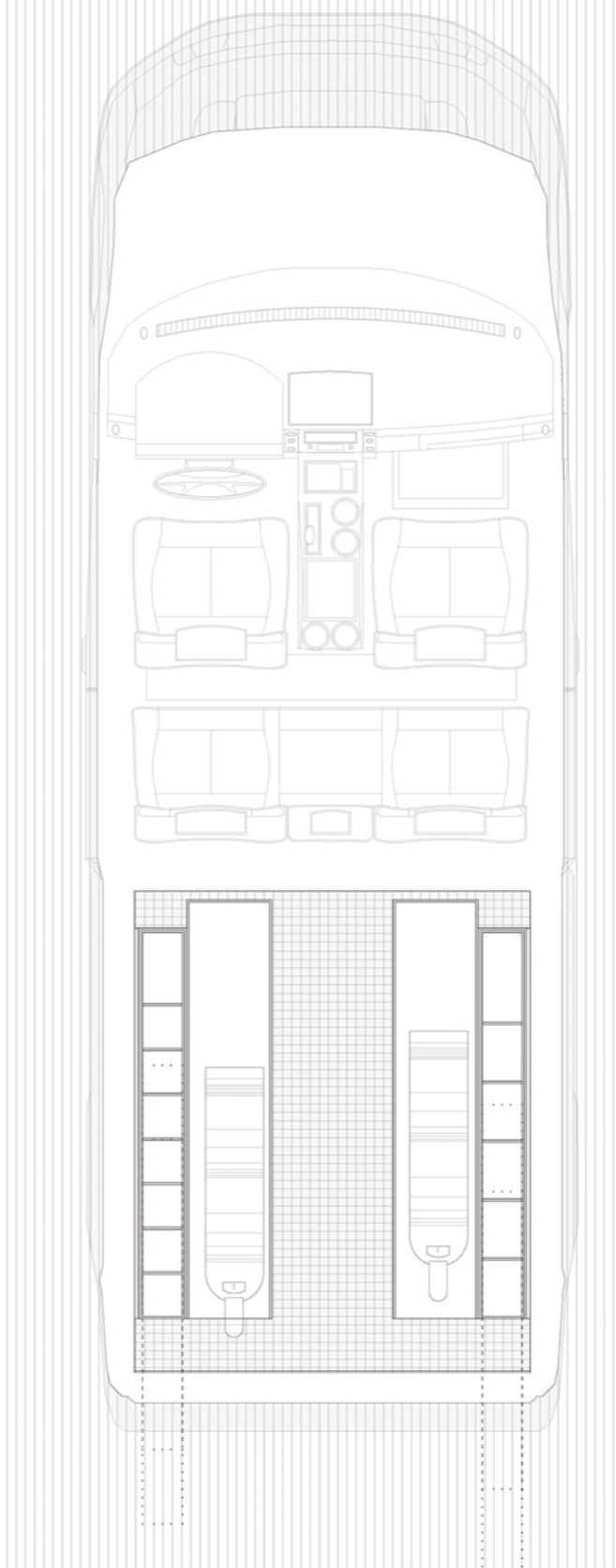
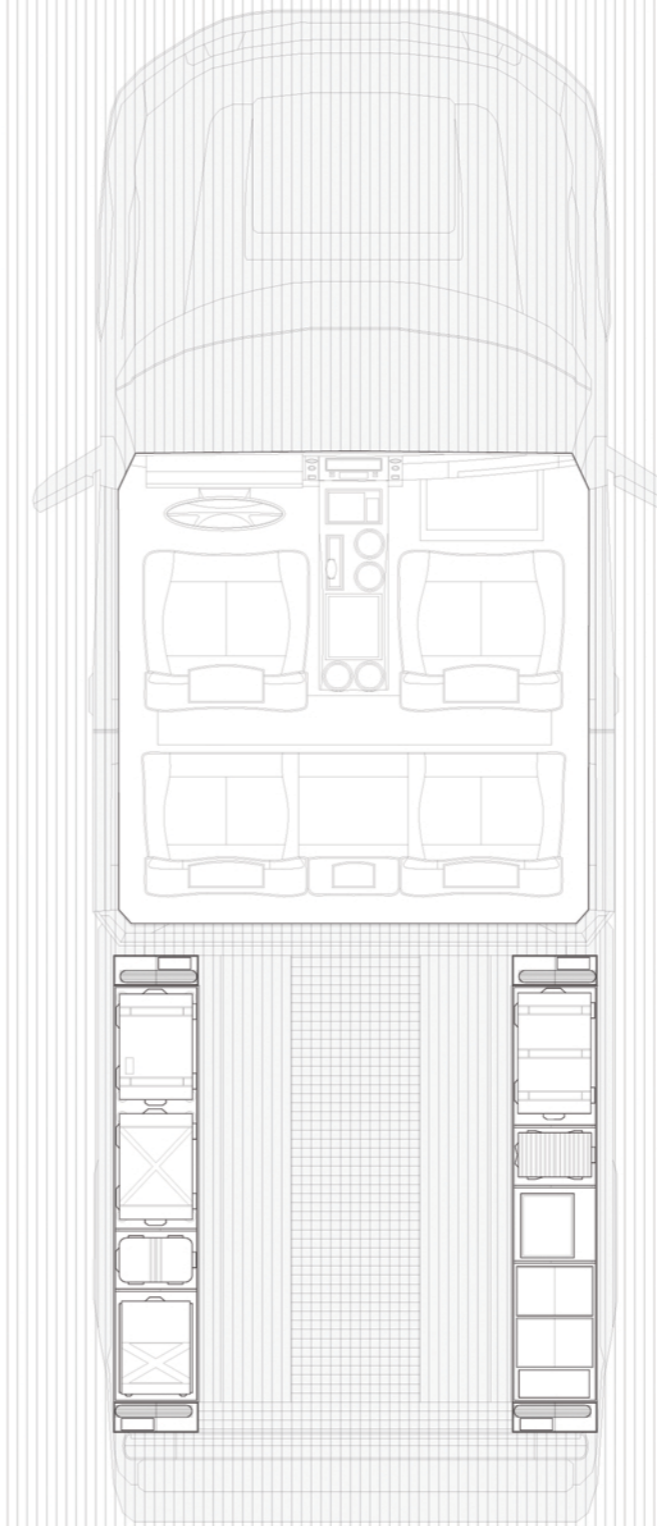
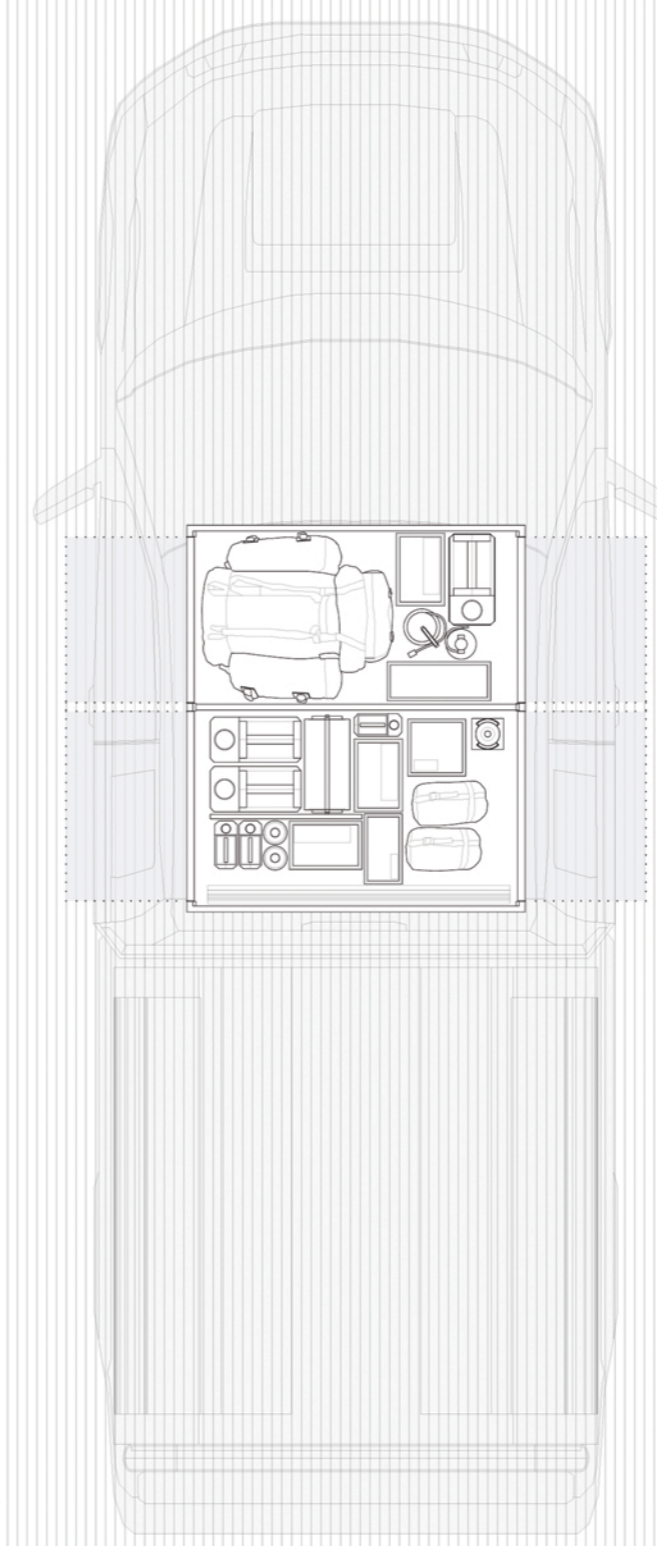
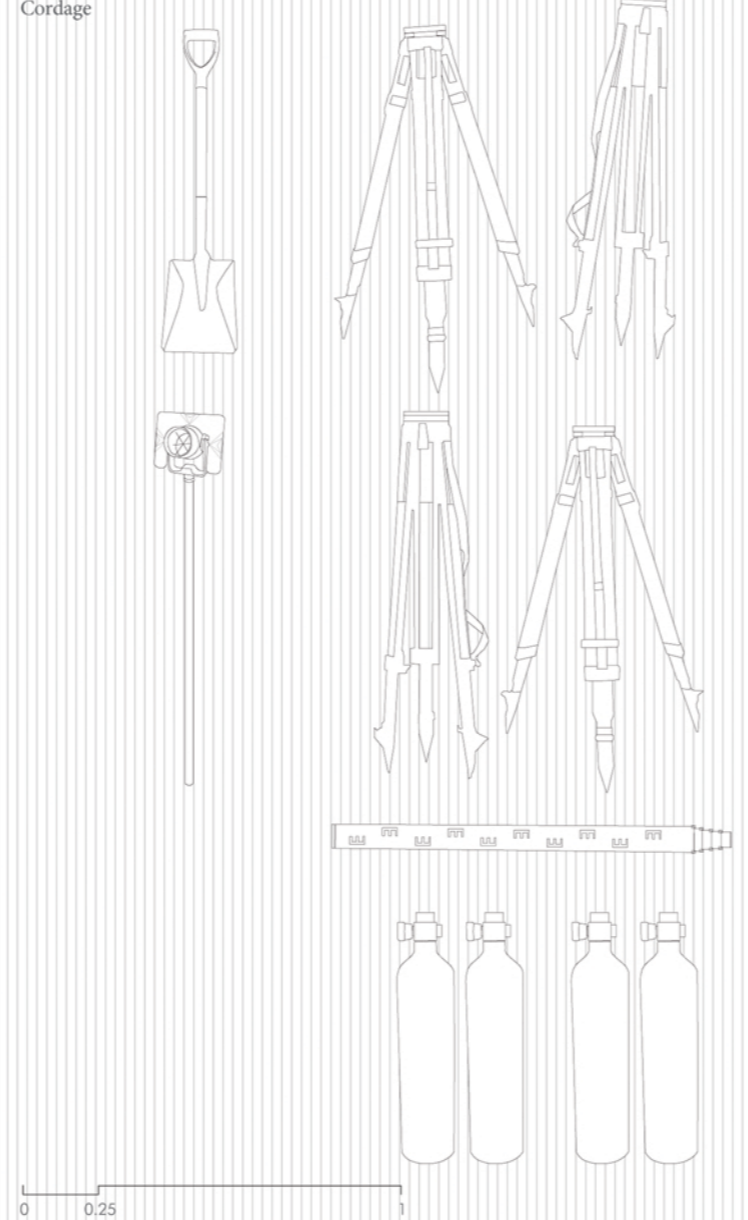

COGNITIVE PROCESS OF LANDSCAPE IDENTIFICATION



- 1 aerial photography
- 2 kinetics map
- 3 photos / questionnaires
- 4 test-tubes
- 5 user guide
- 6 hand lens



www.alessandromusetta.com

LANDSCAPE ARCHITECTURE
A Cognitive Atlas for African Landscapes

Participation at -
8th International Biennial of Landscape Architecture
/ Barcelona Sep25-26-27, 2014



**ALGIERS
TRIPOLI
CAIRO
DJIBOUTI
NAIROBI
MOMBASA
BEIRA
CAPETOWN
LOBITO
KINSHASA
BRAZZAVILLE
LAGOS
DAKAR**

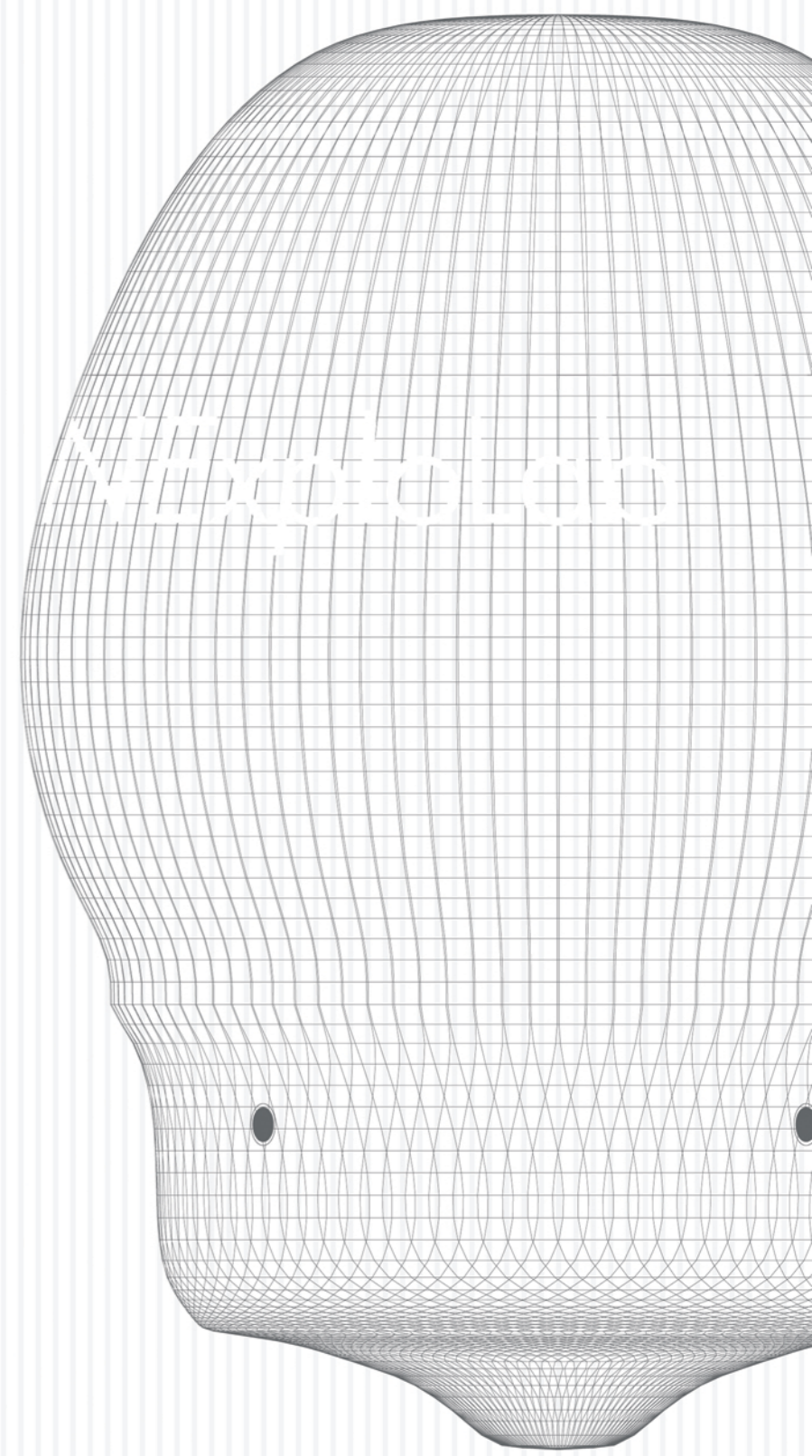

A COGNITIVE ATLAS FOR AFRICAN LANDSCAPES
DEVICE AND APPLICATIONS FOR A CONTEMPORARY EXPLORATION

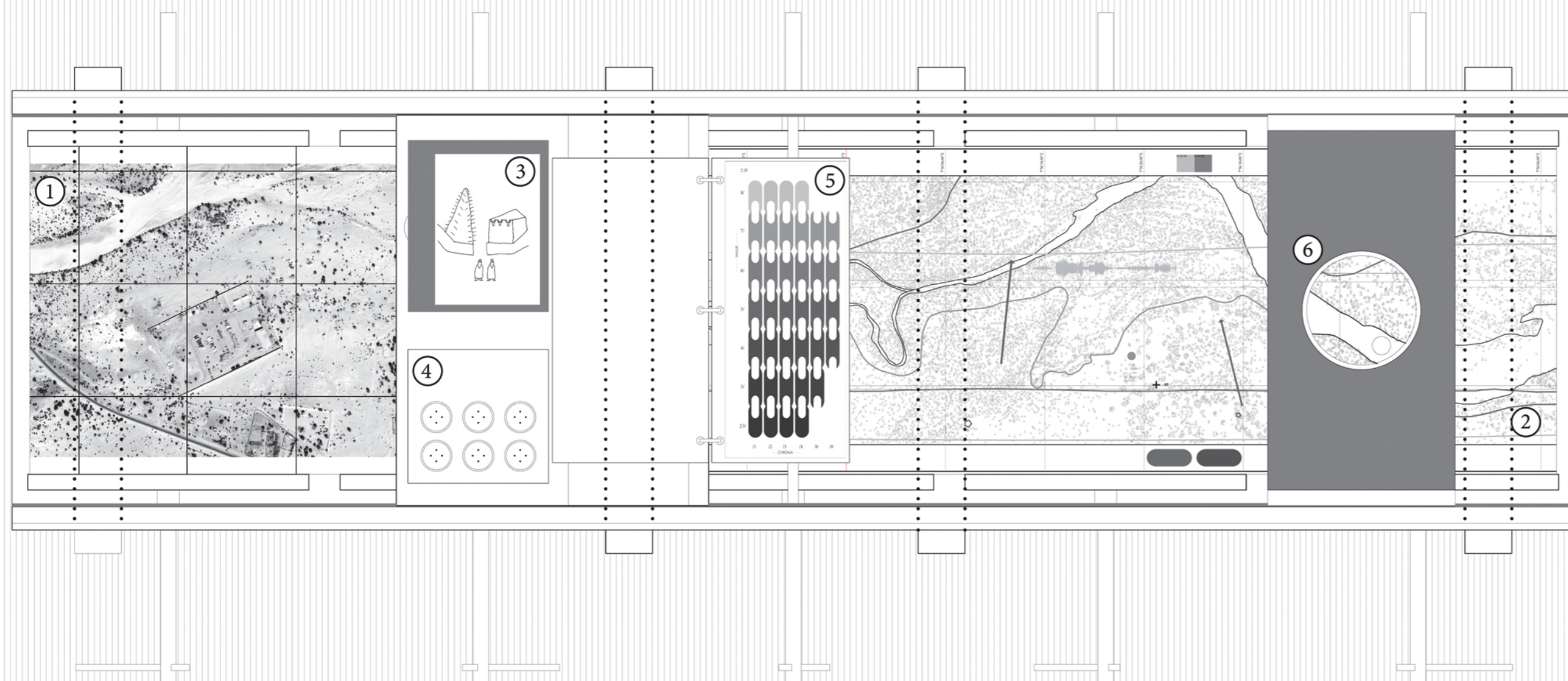

16°57'59,94"N 7°59'00,09"E

AGADEZ
NIGER

Highway N2 / ALGIERS - LAGOS
(Niger: Assamaka - Arlit - AGADEZ - Tanout - Zinder - Magaria)

KINETIC MAPS PLAYER